

EASY TO INSTALL | ENERGY EFFICIENT

NEW LATCH DESIGN

ATTIC HATCH

Featuring a new & improved design, our attic hatch has all the features and benefits for the eco-conscious builder. Easy to install, no-maintenance and extremely energy efficient.



Triple-Edge Seal

Vertical edged weatherstrip on the main PVC frame plus dual brush seals around the hatch for better thermal performance.

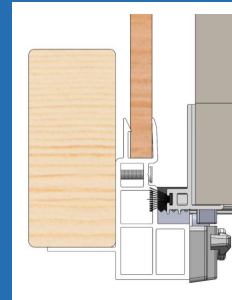

Easy Installation

No-maintenance PVC frame with integrated sealing flange for easier vapour barrier integration.



Easy to Secure

Dual latches with handles make the hatch easy to close and result in better weatherstrip compression for a more air-tight seal.



Available in

**R40
R60**

BENEFITS

- Welded, no-maintenance PVC frame for durability and efficiency
- Cam locks provide increased weatherstrip compression while integrated handles allow for the panel to be easily closed
- Improved thermal performance and condensation resistance
- Eco-friendly hatch is made from recycled door cutout plus a custom-cut block of polystyrene foam
- Set back PVC sealing flange allows for easy finishing
- Included OSB dam ensures attic is accessible
- Quality craftsmanship for long-lasting performance

SPECS

- OSM: 22 1/4" x 30"
- OSB insulation dam height: 13" (R40), 18" (R60)
- 1/2" drywall allowance
- White frame, latches, and EPDM weatherstrip
- Weight: 14kg (R40), 17.5kg (R60)